

NOTES:

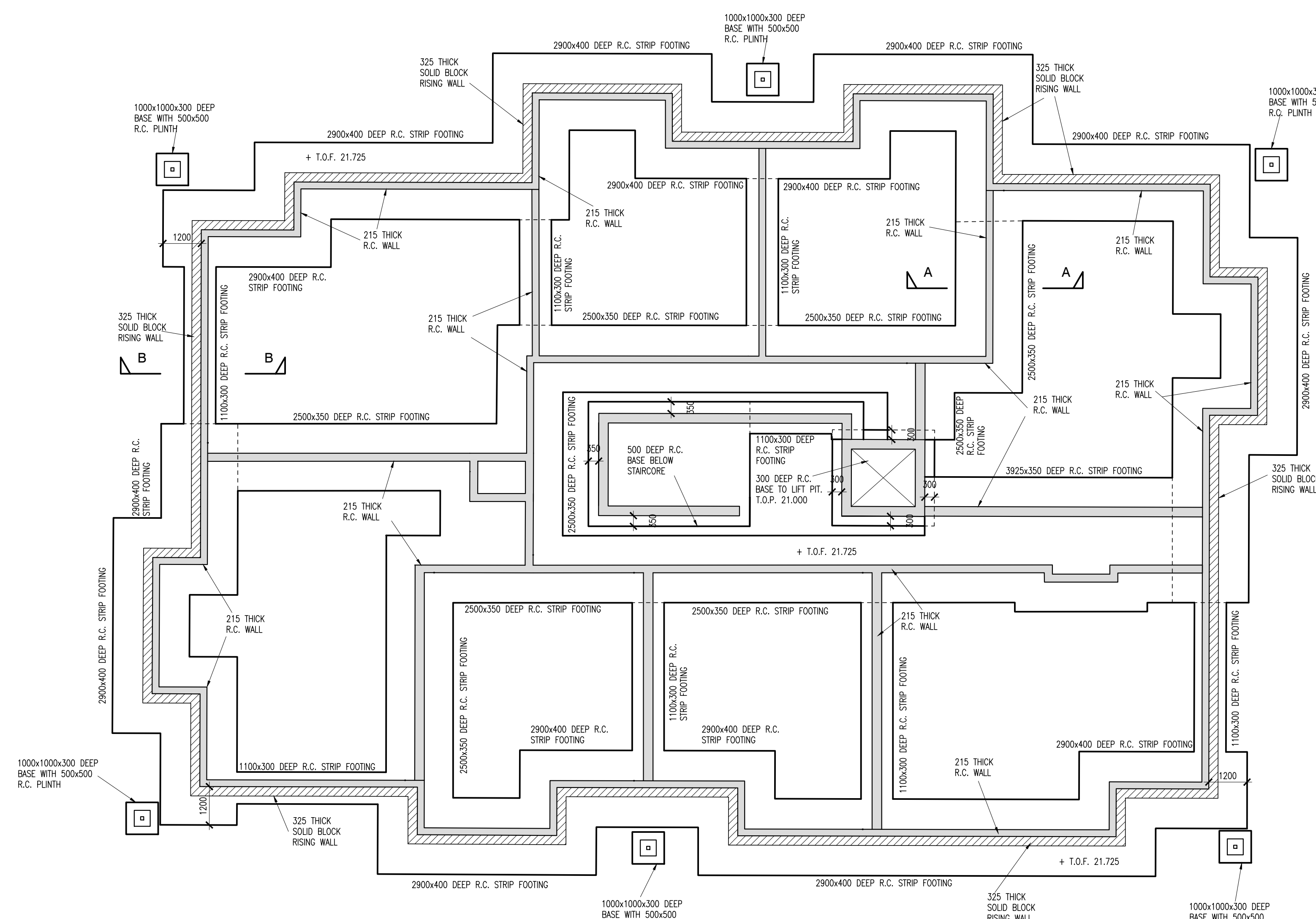

FOUNDATION PLAN (1:100)

GENERAL NOTES:

- FOUNDATION SIZES ARE AS NOTED ON DRAWING. FOUNDATIONS TO BE SET OUT CENTRALLY TO WALLS/COLUMNS TO WHICH THEY SUPPORT UNLESS NOTED OTHERWISE.
- ALL CONCRETE TO BE GRADE C30/37 IN ACCORDANCE WITH IS EN206-1 UNLESS NOTED OTHERWISE.
- ALL MESH REINFORCEMENT TO HAVE A MINIMUM 450mm LAPS UNLESS NOTED OTHERWISE.
- COVER TO REINFORCEMENT IN FOUNDATIONS TO BE 50mm UNLESS NOTED OTHERWISE.
- ALL EXCAVATIONS FOR FOUNDATIONS TO BE INSPECTED BY DBFL PRIOR TO POURING OF CONCRETE.
- ALL WATERPROOFING, TANKING, DPC TRAYS AND D.P.M.s TO ARCHITECTS DETAILS.
- RADON PROTECTION IN ACCORDANCE WITH ARCHITECTS DETAILS.

FOUNDATIONS:

ALL FOUNDATION SIZES ARE INDICATIVE AND SUBJECT TO FURTHER SITE INVESTIGATION WORKS CARRIED OUT ON SITE. T.O.F. INDICATES TOP OF FOUNDATION LEVEL. FINAL LEVEL SUBJECT TO CONFIRMATION ON SITE. FOR SETTING OUT OF ALL WALLS REFER TO ARCHITECTS DRAWINGS.

REINFORCED CONCRETE NOTES:

- REFER TO THE REINFORCEMENT DRAWINGS FOR THE GRADE OF CONCRETE AND THE REQUIRED COVER TO REINFORCEMENT.
- ALL REINFORCEMENT TO BE INSPECTED AND APPROVED BY DBFL PRIOR TO ANY POURING OF CONCRETE.
- SIZE AND SETTING OUT OF ALL SERVICES OPES AS PER ARCHITECTS AND SERVICES ENGINEERS DETAILS.
- CONFIRM REQUIRED FINISH TO ALL CONCRETE ELEMENTS WITH ARCHITECT AND ENGINEER PRIOR TO COMMENCEMENT OF WORKS.
- CONCRETE WORKS SHALL NOT BE CARRIED OUT IF THE AIR TEMPERATURE IS LOWER THAN TWO DEGREES OR IF FROST IS EXPECTED.
- CONCRETE TESTING:
 - THE CONTRACTOR SHALL PROVIDE PROPER EQUIPMENT AND COMPETENT PERSONNEL TO TAKE SAMPLES AND PREPARE TEST SPECIMENS.
 - CUBES TO BE TAKEN AS FOLLOWS:
 - WALLS, SLABS & BEAMS:** FOUR NUMBER CUBES TO BE TAKEN EVERY FOUR TRUCKS OF CONCRETE. TWO NUMBER TO BE TESTED AT SEVEN DAYS OLD AND TWO NUMBER AT TWENTY EIGHT DAYS OLD.
 - FOOTINGS:** FOUR NUMBER CUBES TO BE TAKEN EVERY TEN TRUCKS OF CONCRETE. TWO NUMBER TO BE TESTED AT SEVEN DAYS OLD AND TWO NUMBER AT TWENTY EIGHT DAYS OLD.
 - THE LOCATION OF THE CONCRETE SAMPLED IS TO BE NOTED BY THE TESTER.
 - COPIES OF THE TEST RESULTS ARE TO BE SENT DIRECTLY TO DBFL BY THE APPROVED TESTING AUTHORITY.
 - SHOULD THE SEVEN DAY COMPRESSIVE STRENGTH TESTS BE LESS THAN TWO THIRDS OF THE STRENGTH SPECIFIED, DBFL SHOULD BE CONTACTED DIRECTLY BY PHONE BY THE TESTING AUTHORITY.

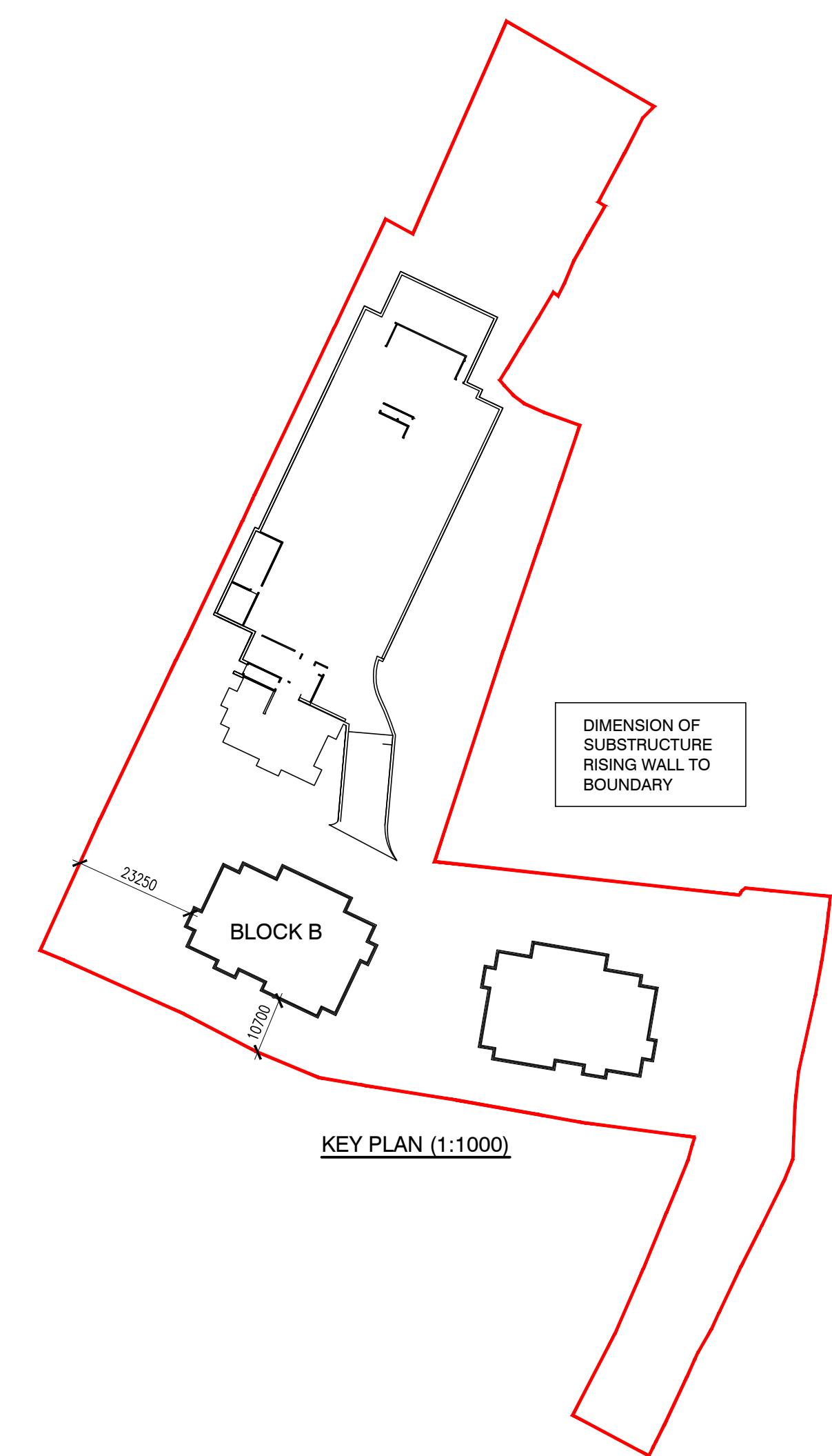

KEY PLAN (1:1000)

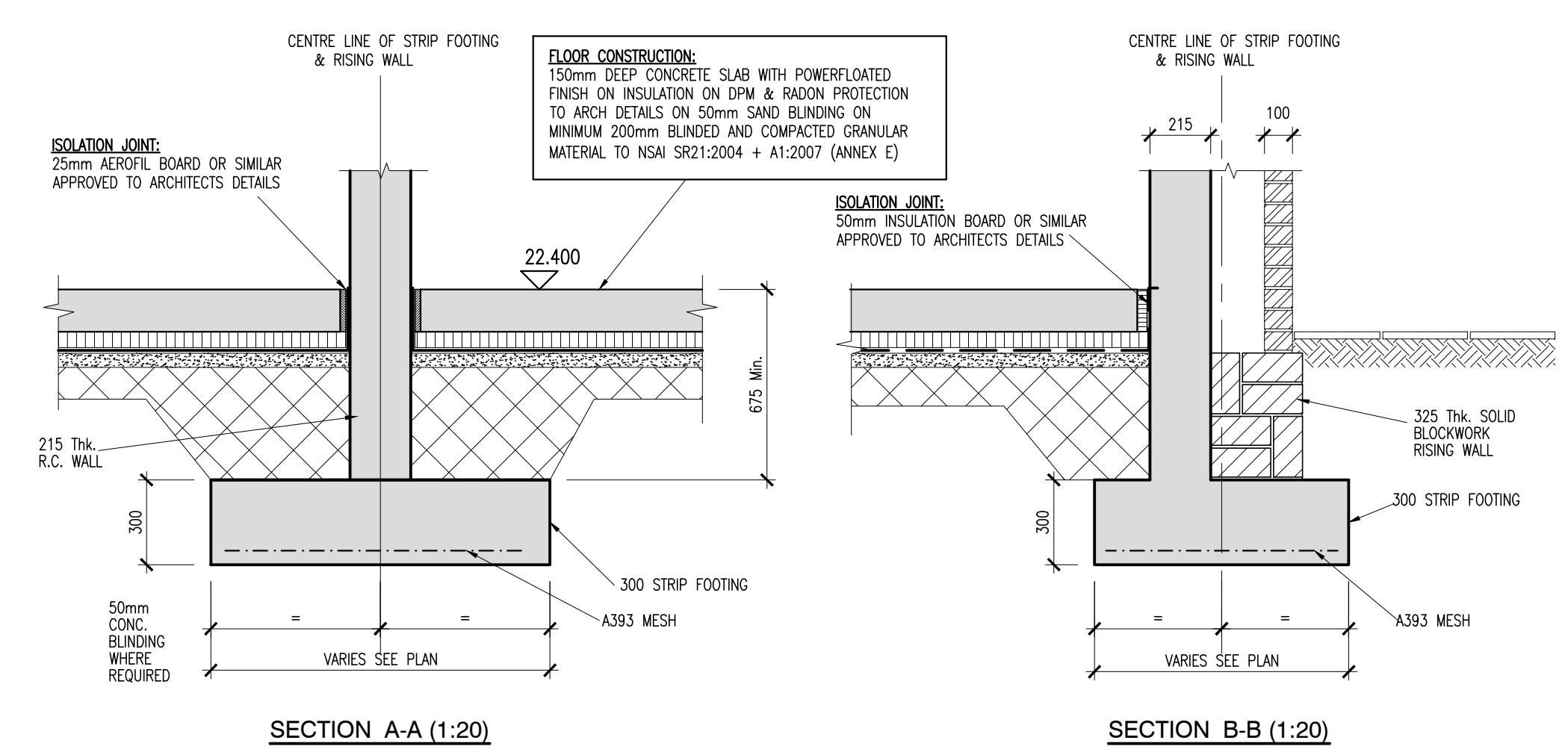

SECTION A-A (1:20)

SECTION B-B (1:20)

| | | | | |
|-----|----------|----------------------------|-----|-------|
| P01 | 17.12.20 | ISSUED FOR INFORMATION | JKJ | JDH |
| rev | date | description | by | chkd. |
| | | A - Approved | | |
| | | B - Approved with comments | | |
| | | C - Do not use | | |

S2 - INFORMATION INFORMATION



DUBLIN OFFICE: Ormond House, Upper Ormond Quay, Dublin 7. D07 W704
PHONE: +353 (0)1 452 4000
CORK OFFICE: Phoenix House, Monahan Road, Cork. T12 H1XY
PHONE: +353 (0)21 2254538
WATERFORD OFFICE: Suite 10, The Atrium, Maritana Gate, Canada Street, Waterford. X91 WQ28
PHONE: +353 (0)51 909 500

NEWTOWNPARK AVENUE SHD

drawing title
**BLOCK B
FOUNDATION PLAN**

client
HJ LYONS ARCHITECTS

| | | | |
|---------------------------|--------|-------|------------|
| designed by | author | scale | sheet size |
| JDH | JKJ | 1:200 | A1 |
| drawing no. | | | revision |
| 190146-DBFL-B1-F1-DR-8000 | | | P01 |